



**FRONT RUNNER**  
VEHICLE OUTFITTERS

## STAINLESS STEEL BRAAI/BBQ COOKING GRATE

ENG

VACC023

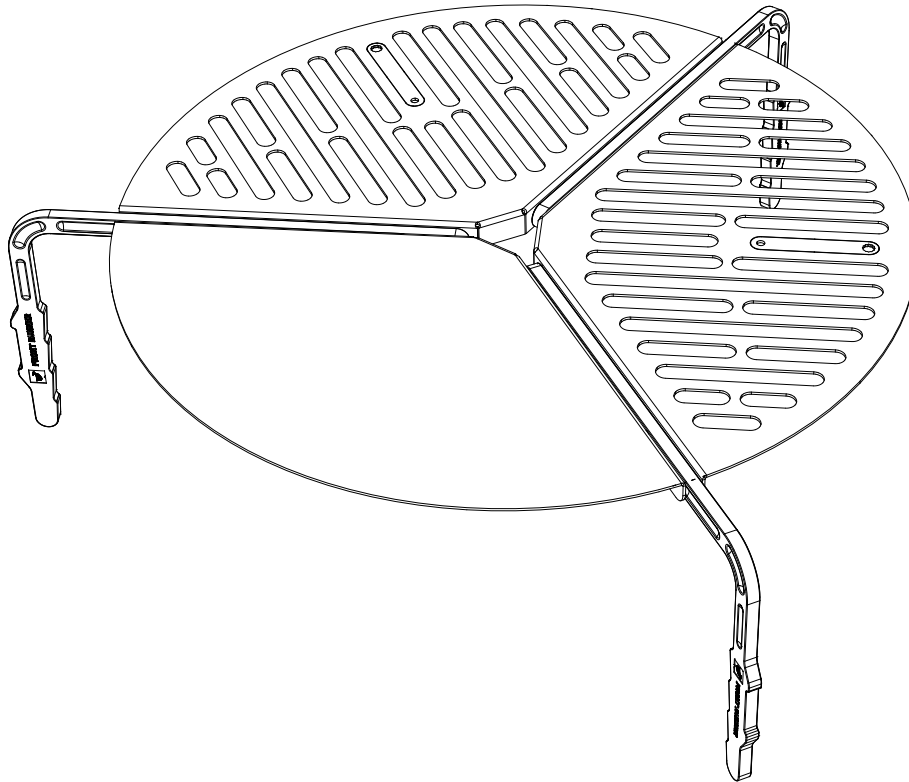

### READ ME !

Thank you for purchasing a Front Runner Stainless Steel Braai/BBQ Cooking Grate.  
Before you start, take a moment to familiarize yourself with this Fitting Instruction and the components received.  
Refer to Page 2 for a list of all the components, quantities and tools required.

### IMPORTANT WARNING!

IT IS CRITICAL THAT ALL FRONT RUNNER PRODUCTS BE PROPERLY AND SECURELY ASSEMBLED AND ATTACHED TO YOUR VEHICLE.  
IMPROPER ATTACHMENT COULD RESULT IN AN AUTOMOBILE ACCIDENT, AND COULD CAUSE SERIOUS BODILY INJURY OR DEATH.  
YOU ARE RESPONSIBLE FOR ASSEMBLING AND SECURING ALL FRONT RUNNER PRODUCTS TO YOUR VEHICLE. CHECKING THE ATTACHMENTS PRIOR TO USE, AND PERIODICALLY INSPECTING THE PRODUCTS FOR ADJUSTMENT, WEAR AND DAMAGE.  
THEREFORE YOU MUST READ AND UNDERSTAND ALL OF THE INSTRUCTIONS AND PRECAUTIONS SUPPLIED WITH YOUR FRONT RUNNER PRODUCT PRIOR TO INSTALLATION OR USE.  
IF YOU DO NOT UNDERSTAND ALL OF THE INSTRUCTIONS AND CAUTIONS, OR IF YOU HAVE NO MECHANICAL EXPERIENCE AND ARE NOT THOROUGHLY FAMILIAR WITH THE INSTALLATION PROCEDURES,  
YOU SHOULD HAVE THE PRODUCT INSTALLED BY A PROFESSIONAL INSTALLER OR OTHER QUALIFIED PERSONNEL.

1

## GET ORGANIZED

Here is what you are looking at for VACC023

### IN THE BOX

|   |      |                  |
|---|------|------------------|
| 1 | 3 X  | Leg              |
| 2 | 3 X  | Spacer           |
| 3 | 3 X  | Grid             |
| 4 | 12 X | M5 x 25 Hex Bolt |
| 5 | 12 X | M5 Hex Nut       |
| 6 | 2 X  | Spanner/Wrench   |

### TOOLS NEEDED

Spanner/Wrench supplied with braai grate.

FIGURE 1.1

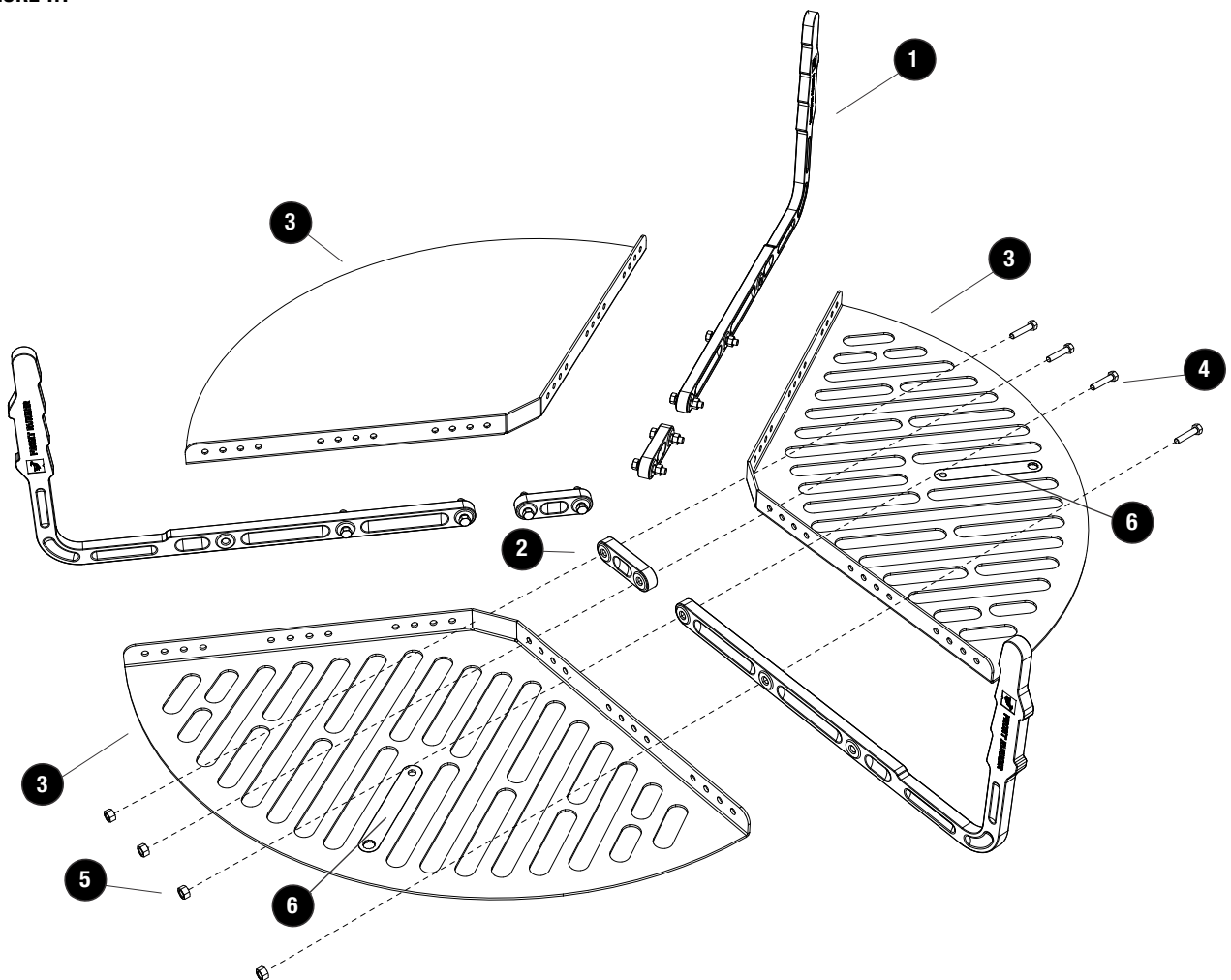

**2****ASSEMBLY OF BRAAI / BBQ COOKING GRATE**

**TIP:** If your spare wheel is the same diameter, remove it and lay it flat on the ground. Use the spare wheel as a guide to adjust and position the Braai / BBQ cooking grate legs to the correct position.

For tyre diameters ranging from 740mm – 840mm ( 29" - 33") the spacers are not required.  
For tyre diameters ranging from 840mm ( 33" - 35") the spacers must be used.

Secure the legs in place with items 4 and 5 using the 2 wrench's provided in the cooking grate.

Test fit the assembled Braai / Cooking grate over the spare wheel to insure it is set correctly. There should be a slight resistance with the legs going over the tyre to insure a proper and secure fit.

Should the resistance be too much, remove the legs and reposition to the next hole.  
Reposition only one leg for a small increment, two legs for a bigger increment or all three legs.

**NB: THE RESISTANCE SHOULD NOT BE TOO MUCH AS THIS MAY LEAD TO EXCESS STRESS IN THE LEGS.**

If set correctly no additional strapping is required to secure the braai / cooking grate to the tyre, but should the tyre tread be worn or tyre diameter not match up with the holes provided, an endless ratchet strap may be used to secure the legs to the tyre and insure a secure fit. The strap must be placed in the legs recess to insure it does not slide off.

2.1

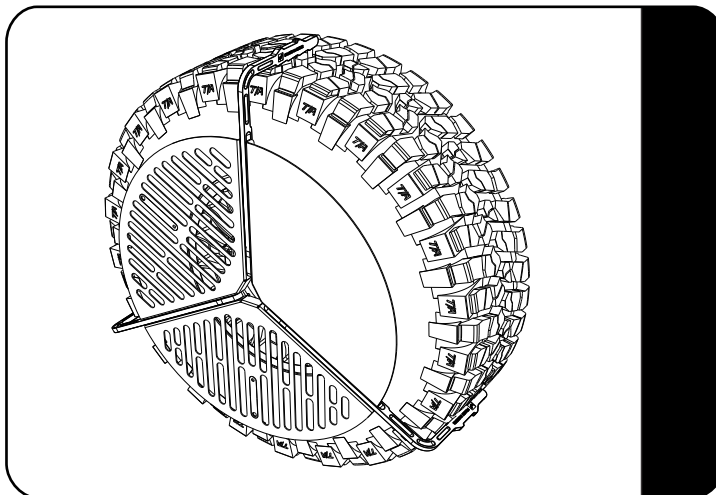

Cooking Gate secured to tyre with no additional strap.

2.2

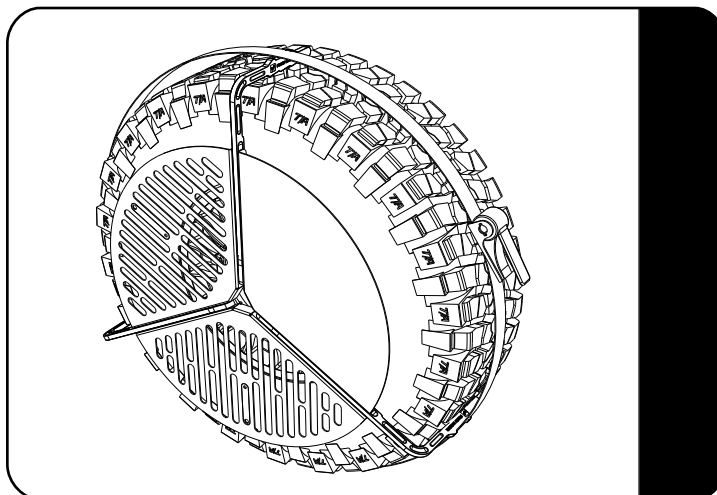

Cooking Gate secured to tyre with additional ratchet strap.

**3**

## COMPLETION

3.1



**Congratulations. You did it. Take a step back and admire your work!**

**4**

## INSTALL OTHER VEHICLE AND RACK ACCESSORIES

Now's the time to visit your favorite Front Runner Dealer in person or online.