



•HINT• *Please consult  
**FRONTRUNNEROUTFITTERS.COM** should  
you have any queries.*

INSTALL TIME: 0.75 hours



## 1 GET ORGANIZED

you will need:

- a Gelandewagen with double rear doors
- a 4 mm allen key
- a 10 wrench
- a drill
- a 3mm drill bit (for pilot holes)
- a 8 mm drill bit
- a 15 mm drill bit
- a round file
- a black marker
- a centre punch
- a screw driver (flat)
- a screw driver (Philips)

...CONT'D

### IMPORTANT WARNING!

IT IS CRITICAL THAT ALL FRONT RUNNER RACKS AND ACCESSORIES BE PROPERLY AND SECURELY ATTACHED TO YOUR VEHICLE. IMPROPER ATTACHMENT COULD RESULT IN AN AUTOMOBILE ACCIDENT, AND COULD CAUSE SERIOUS BODILY INJURY OR DEATH TO YOU OR TO OTHERS. YOU ARE RESPONSIBLE FOR SECURING THE RACKS AND ACCESSORIES TO YOUR CAR, CHECKING THE ATTACHMENTS PRIOR TO USE, AND PERIODICALLY INSPECTING THE PRODUCTS FOR ADJUSTMENT, WEAR, AND DAMAGE. THEREFORE, YOU MUST READ AND UNDERSTAND ALL OF THE INSTRUCTIONS AND CAUTIONS SUPPLIED WITH YOUR FRONT RUNNER PRODUCT PRIOR TO INSTALLATION OR USE. IF YOU DO NOT UNDERSTAND ALL OF THE INSTRUCTIONS AND CAUTIONS, OR IF YOU HAVE NO MECHANICAL EXPERIENCE AND ARE NOT THOROUGHLY FAMILIAR WITH THE INSTALLATION PROCEDURES, YOU SHOULD HAVE THE PRODUCT INSTALLED BY A PROFESSIONAL INSTALLER SUCH AS A QUALIFIED GARAGE OR AUTO BODY SHOP.

# 1

## GET ORGANISED

...CONT'D

Here is what you are looking at:

Auto #	Quantity	DESCRIPTION
1	1	GELANDEWAGEN RHS REAR DOOR
2	1	BASE ASSEMBLY
3	1	TRAY ASSEMBLY
4	1	STRUT
5	4	M4 x 10 COUNTERSUNK SCREW
6	4	M6 x 10 BUTTON HEAD CAP SCREW
7	1	DRILL TEMPLATE 1
8	1	DRILL TEMPLATE 2
9	2	M6 NUT
10	2	DRILL TEMPLATE 1 BOLT ASSEMBLY

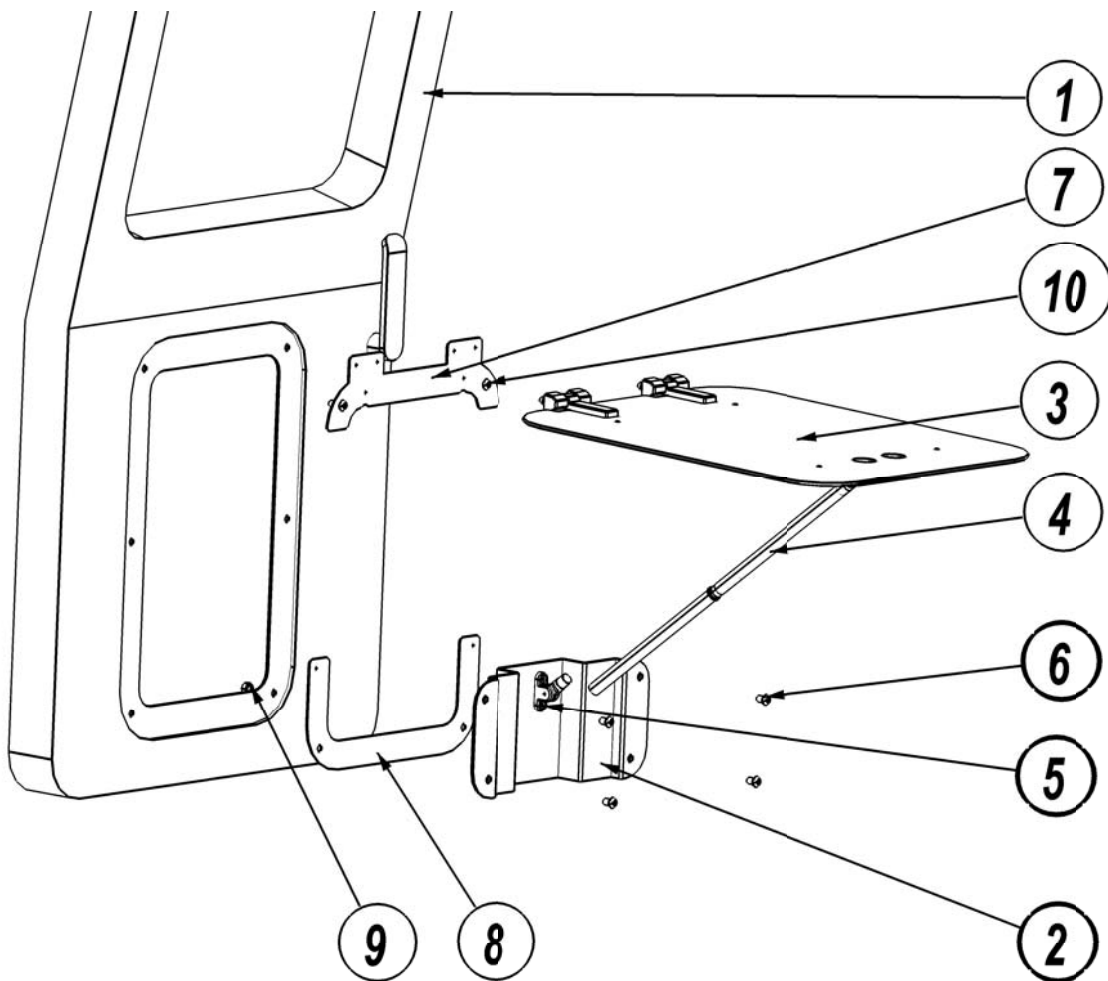

### B)

Familiarize yourself with the parts and then step away from the work area and read through these instructions from beginning to end. Grab a cup of coffee and take a moment. A little prep now may save you a lot of time later

## 2

### DRILL HINGE HOLES

A)

Remove the inside door panel on the right hand side by wedging the panel off with a flat screw driver. Note where the clips are located by getting an idea from the holes in the sketch. Align the drilling template (Item 2) using the lower holes to align with the holes in the door. Use the Drill Template Bolt Assembly (Item 3) to hold the Template in position. (One nut on each side acts as a spacer to allow the template to fit flush on the door. See diagram)

B)

Using the template as a guide, grab the drill with the 3mm bit and drill the 6 pilot holes (see arrows)

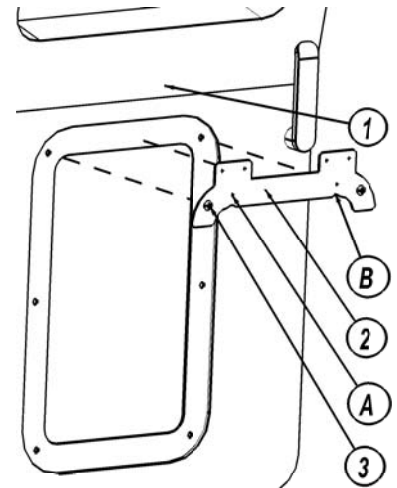

C)

Once all the pilot holes have been drilled, use the 8mm drill bit and drill the holes. Use the 15mm drill bit to drill the holes marked "A". Use the round file to make the shape "B" in the door. Clean and smooth off with a round file.

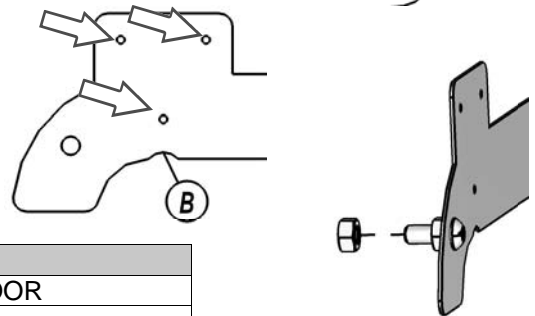

Auto #	Quantity	DESCRIPTION
1	1	GELANDEWAGEN RHS REAR DOOR
2	1	DRILL TEMPLATE 1
3	2	DRILL TEMPLATE 1 BOLT ASSEMBLY

## 3

### DRILL BASE HOLES

A)

Align the drilling template (Item 2) using the lower holes to align with the holes in the door. Mark the holes with the marker and the centre punch

B)

Using the template as a guide, grab the drill with the 3mm bit and drill the pilot holes

C)

Once all the pilot holes have been drilled, put the 8mm drill bit in and drill the holes.

D)

Remove the template and keep the Button Head Cap Screws as you will need these to attach the base plate.

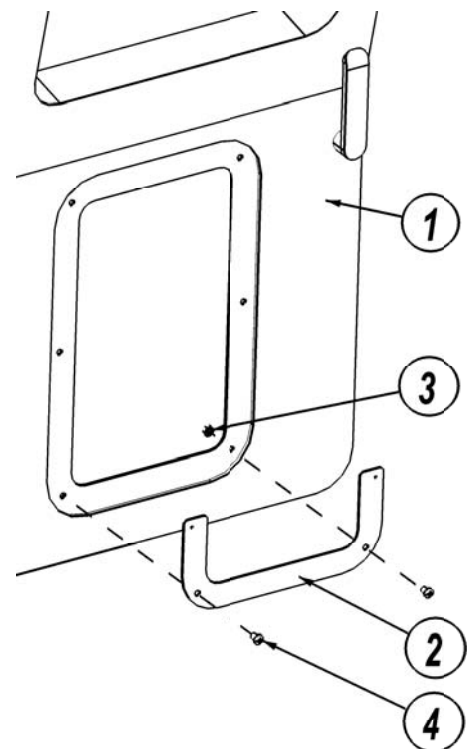

Auto #	Quantity	DESCRIPTION
1	1	GELANDEWAGEN RHS REAR DOOR
2	1	DRILL TEMPLATE 2
3	2	M6 NUT
4	2	M6 x 10 BUTTON HEAD CAP SCEW

# 4

## MOUNT THE BASE PLATE

A)

Place the base plate inside the door cavity and fasten it to the door with the M6 button head cap screws (use the bottom 2 existing holes in the door and the 2 holes that you drilled in step 3) and a 4 mm allen key. SEE DIAGRAM. Note: The strut foot must be at the top and to the right as you look at it.

Note: You might want to put a M6 washer between the base assembly and the door to prevent the ends of the door from being squashed when you tighten the Button Heads.

Auto #	Quantity	DESCRIPTION
1	1	GELANDEWAGEN RHS REAR DOOR
2	1	BASE ASSEMBLY
3	4	M6 x 10 BUTTON HEAD CAP SCREW

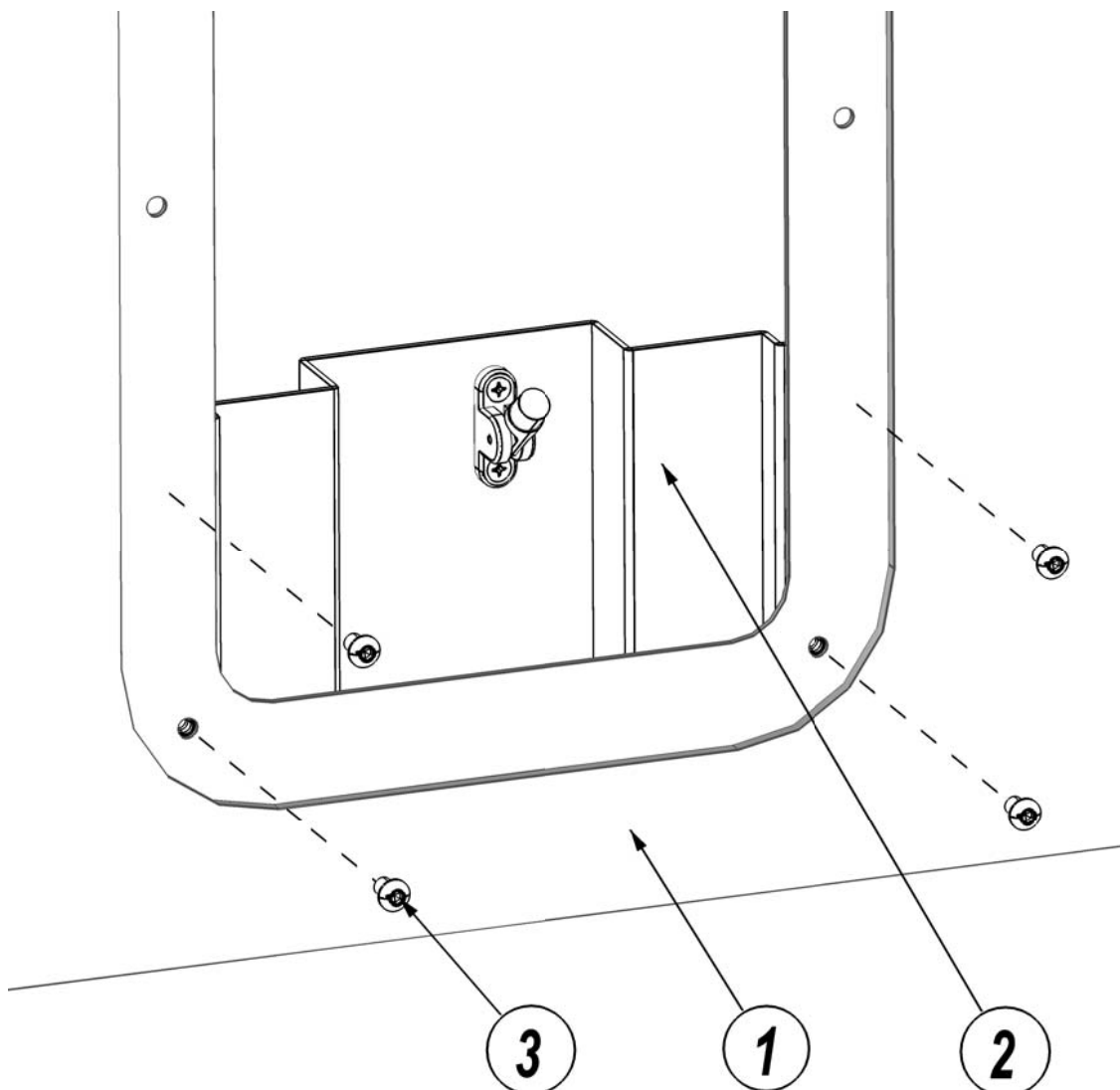

# 5

## INSTALL THE TRAY TOP

A)

Remove the nuts from the back of the hinges and put them in the back of the vehicle. You will need them close by as you will have to hold the tray top in position while fastening the nuts. Insert the hinge studs into the 7mm holes you drilled and tighten with the 10 spanner

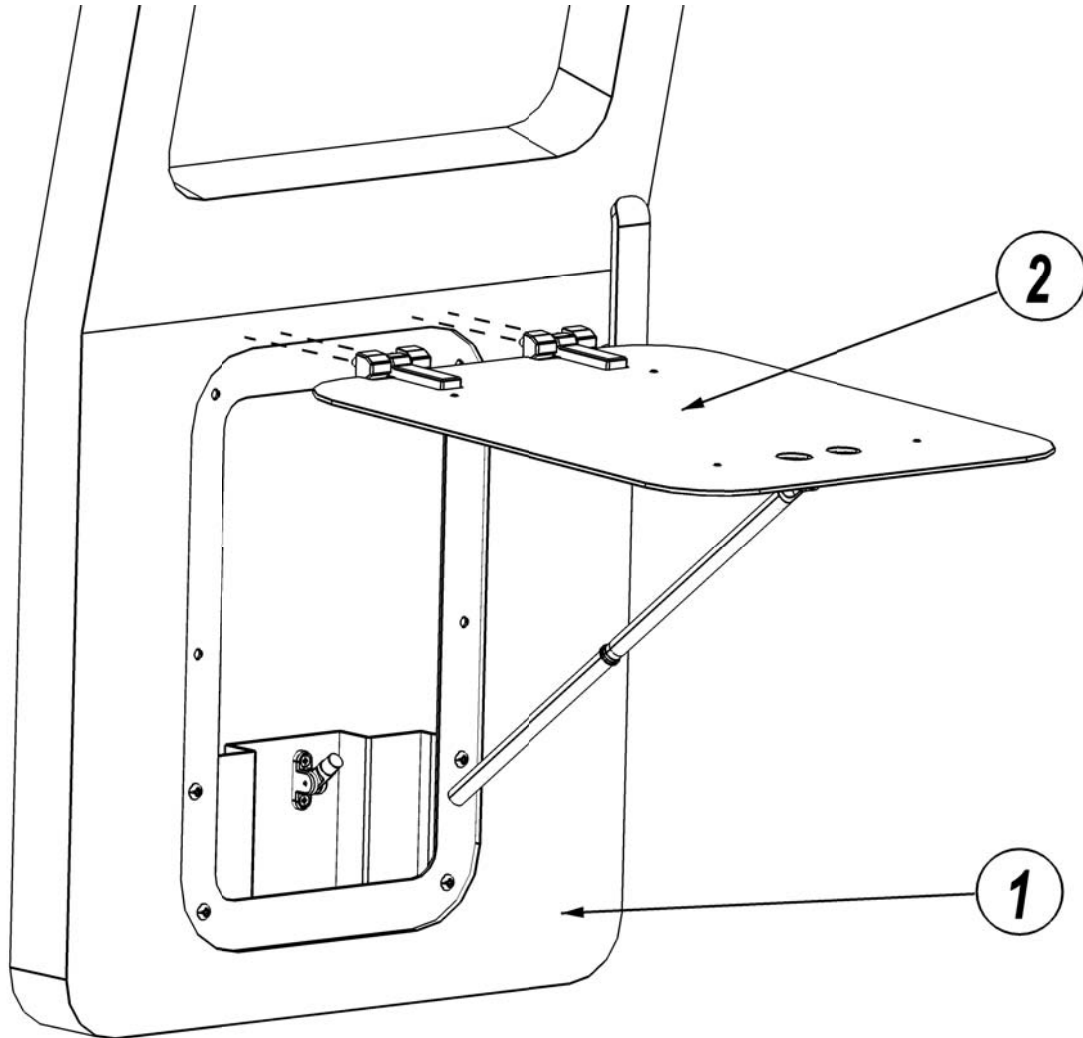

Auto #	Quantity	DESCRIPTION
1	1	GELANDEWAGEN RHS REAR DOOR
2	1	TRAY TOP

...CONT'D

**5**

## **INSTALL THE TRAY TOP** ...CONT'D

B)

Screw the strut shaft to the strut foot attached to the base assembly. The amount you screw the shaft into the foot allows you to vary the table angle. Don't forget, adjustment can be made on both ends of the strut. A drop of locktite might be in order once the ideal position is found.

C)

Check the operation of the table. Close the table by lifting up on the tray and collapsing the strut. Close the tray- the magnets should attach to the base assembly holding the tray shut, flush with the surface of the door.

Should the magnets not be attaching strongly to the base assembly, remove the magnets using a Philips screwdriver and add a washer to the back of the magnet to space it to the desired position- this will allow the magnets to attach strongly!

**6**

## **CHECK FOR OTHER COOL ACCESSORIES**

Now's the time to take a trip to your dealer or visit [www.FRONTRUNNEROUTFITTERS.COM](http://www.FRONTRUNNEROUTFITTERS.COM) for the best accessories for your vehicle!

**7**

## **TAKE A TRIP**

A)

After your first adventure, check the tension on all the bolts and screws and re-tighten where needed. You'll find a small amount of settling has happened.

B)

Go on many more adventures. Periodically check the bolts- it's always wise to double check your fasteners once in a while.

→ **Modifying your vehicle involves some risks and may void certain aspects of your vehicle's warranty.**